

WE INSPIRE HUMAN POTENTIAL



ARENA RENTALS

EFFECTIVE APRIL 1, 2016 – JUNE 30, 2017



Arena Rental Rates

USER TYPE	RATES	IN EFFECT
Youth non-prime	\$110.00	Weekdays 6:00am – 4:00pm
Youth prime	\$220.00	Weekdays after 4:00pm, all day on weekends
Adult non-prime	\$137.00	Weekdays 6:00am – 4:00pm
Adult prime	\$275.00	Weekdays after 4:00pm, all day on weekends

2016/2017 Winter Season (September – March)

2017 Spring Season (April – July)

2017 Summer Season (July – August)

REQUEST DEADLINE: May 31, 2016

REQUEST DEADLINE: December 15, 2016

REQUEST DEADLINE: November 1, 2016



403.247.5492
arenainfo@winsport.ca
winsport.ca

*For inquiries using facility as venue for tradeshow, weddings, concerts, etc.
please contact our sales team at 403-247-5607 or salesinfo@winsport.ca*



RULES & REGULATIONS

In order to operate the Markin MacPhail Centre Ice Arenas in a safe and efficient manner, expectations are that all users shall abide by the following rules and regulations:

- Smoking is prohibited in all areas of the facility and within 7.5 meters of any public entrance
- Consumption of alcohol is permitted in licensed areas only
- Children under the age of 14 are to be supervised at all times by a parent or a designated adult. A minimum of two coaches or designated adults should be in the dressing rooms with individuals under the age of 18
- Users must abide by their scheduled practice/game times. No players are allowed on the ice surface without their coaches being present and without the proper equipment
- Sticks and pucks are to be used on the ice surface only. Persons hitting sticks or pucks against walls, etc. will have their equipment confiscated and will be required to clean the area or pay for damages & an administration fee of 18%
- No one is to be on the ice while the Ice Resurfacer is being operated, unless instructed by staff to assist. Wait until Ice Resurfacer gates are closed before going using the ice
- Spectators found throwing debris onto the ice surface or using vulgar language will be immediately ejected from the facility
- All fire exits, hydrants, doors or any other marked areas clear. Vehicles or bicycles blocking them will be towed or removed at the owner's expense
- Anyone activating the emergency sprinkler system without cause to do so will be required to pay for damages / lost revenue, and may face criminal charges
- WinSport is not responsible for lost or stolen articles
- No outside food or beverages may be brought into the facility without prior written consent
- Bicycles, skateboards, scooters, heelies, hoverboards, and pets are not permitted within the facility

Dressing rooms are to be left in a neat and orderly manner and vacated within 30 minutes after rental time has ended. Any infraction of the rules will result in a minimum surcharge of \$75.00 (there will be no warnings) and will need to be paid before licensee's next scheduled activity. Licensees' scheduled time will be suspended if accounts are not up to date. **The host team or name on the license is responsible for the visiting team's:**

- Excessive debris or garbage on floors, walls, benches, ceiling, etc.
- Any evidence of use of tobacco products
- Excess water on floors, walls, benches, ceiling, mirrors, etc.
- Damage, marks and spit on columns, doors, hardware, fixtures, walls, benches, etc.
- Urine or human waste on any property
- Fighting, swearing, or inappropriate behavior; and
- Shooting or playing with sticks, pucks and balls

Use of WinSport facilities are at the user's own risk.

WinSport reserves the right to refuse renting arena facilities to anyone.

PARKING

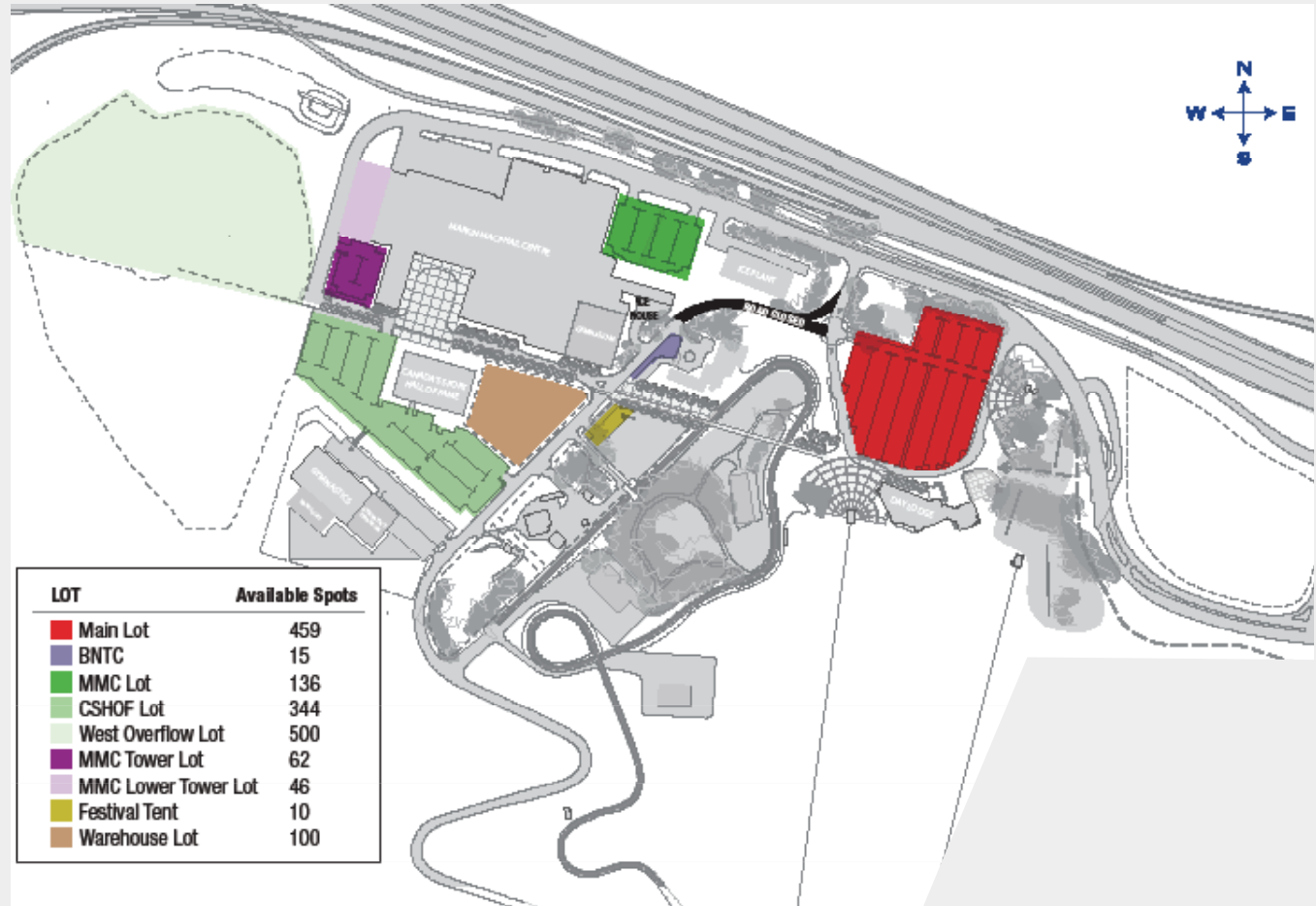

EMERGENCIES

MP Muster Points

+ First Aid

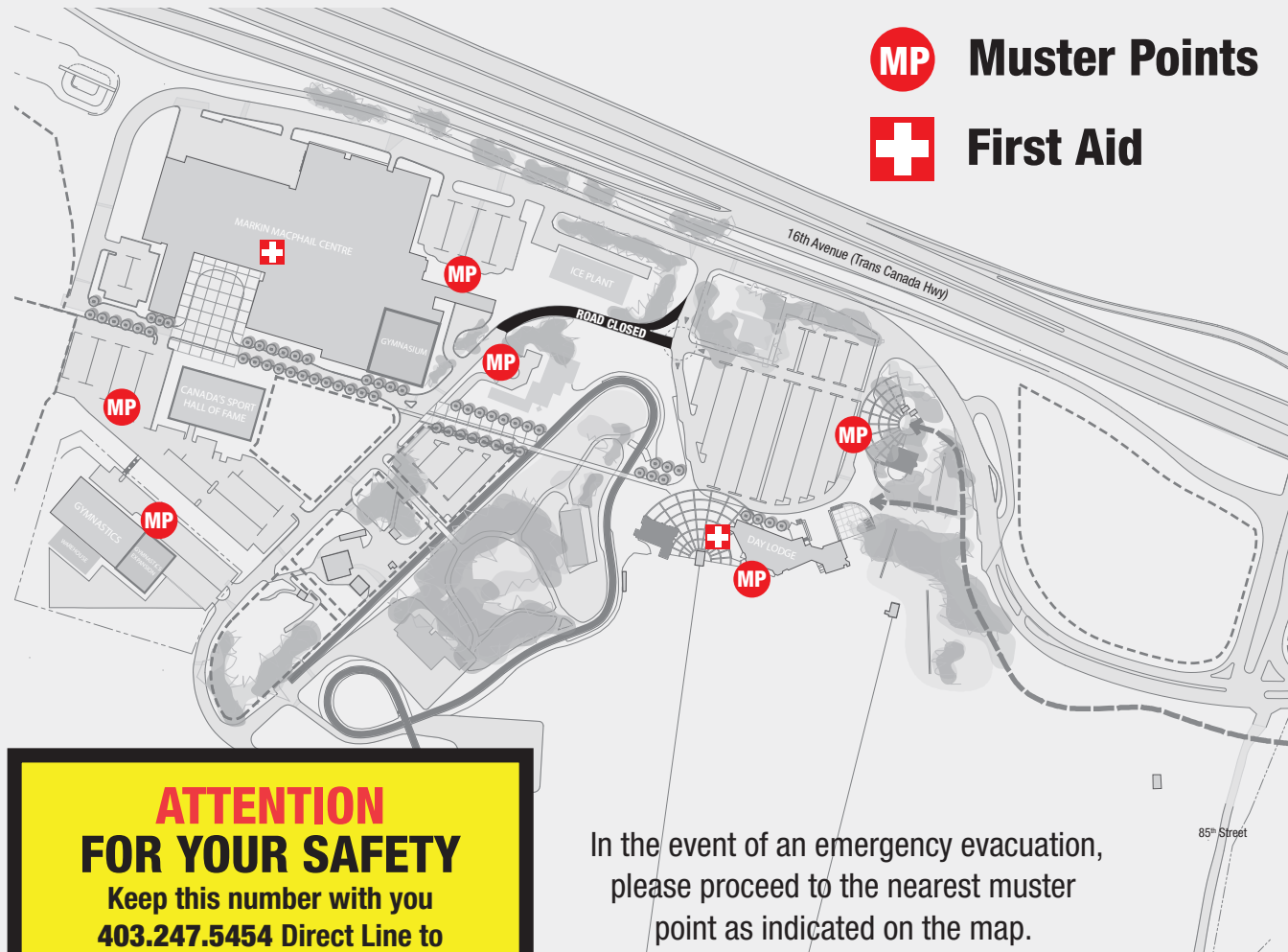

ATTENTION
FOR YOUR SAFETY
Keep this number with you
403.247.5454 Direct Line to
WinSport Dispatch, Patrol & Security

In the event of an emergency evacuation,
please proceed to the nearest muster
point as indicated on the map.

403.247.5492
arenainfo@winsport.ca
winsport.ca



Emergency Procedures Cont'd



FIRE

The Markin MacPhail Centre is equipped with several fire detection and fire suppression systems. If a fire is observed, fire extinguishers are located throughout each level of the facility. In the event of a fire, activate a manual pull alarm station. The alarm monitoring company advises the Calgary Fire Department as well as WinSport Dispatch. If there is no pull station present or a fire is noticed from outside, call 911, then notify WinSport Dispatch at 403.247.5454 or via the blue emergency call boxes, if safe to do so. Evacuate the area immediately.



MEDICAL EMERGENCY

In case of a medical emergency, inform WinSport dispatch at 403.247.5454 or via the blue emergency call boxes. If there is an immediately life threatening condition call 911. WinSport covers the grounds during operational hours with a team of trained emergency medical staff and is equipped to handle the majority of incidents requiring immediate care. Automated external defibrillators are located on all three levels of the Markin MacPhail Centre.



EMERGENCY EVACUATION

In the event of an emergency evacuation for any reason the fire alarm will sound and a message will be voiced over the building intercom. Everyone is to evacuate the building and proceed to the nearest muster points, located on the NE and SW corners of the facility. WinSport emergency personnel will be at the muster points to give further information and facilitate a full park-wide evacuation as required.

When placing an emergency call, provide the **911** operator with the following information:

1. Nature of the emergency
2. Call back number
3. Location of the emergency
4. Your name or the name of the person reporting the emergency
5. **DO NOT HANG UP** until told to do so
6. Contact WinSport Dispatch 403.247.5454

AMENITIES

GUEST SERVICES

Located on the first floor of the Markin MacPhail Centre.

Monday - Thursday 6am - 10pm
Friday 6am - 8pm
Saturday 8pm - 8pm
Sunday 9am - 3pm

GARDENcafé

The Café is the perfect place to unwind after an exciting hockey game, to meet before a training session or grab a quick snack on the go. Options include hot and cold meals, Starbucks brewed coffee, smoothies, and snacks.

Daily 8am - 10pm



WinSport is excited for the Molson Canadian Hockey House on the second floor of the Markin MacPhail Centre. Open daily, enjoy great pub food in casual family friendly atmosphere that overlooks the International Arena.

Daily 5pm - 11pm



WinSport is proud to partner with Breakaway Sports Repair Shop to offer state-of-the-art skate sharpening. Using the latest technology from Blackstone, they offer both conventional sharpening and the flat bottom V. Don't forget to ask about team rates and sharpening cards.

Monday - Friday 11am - 10pm
Saturday - Sunday 8am - 10pm



CANADA'S SPORTS
 HALL OF FAME
 PANTHÉON DES
 SPORTS CANADIENS

Canada's Sports Hall of Fame features a 40,000 square foot gallery sharing the stories of over 530 honoured members representing 62 sports in 12 interactive galleries. Learn about Canada's sporting traditions and artifacts with over 50 interactive exhibits and an award winning short film highlighting greatness in sport.

Tuesday - Sunday 10am - 5pm
Summer Daily 10am - 5pm